

ILLUSTRATIONS

DRAWINGS

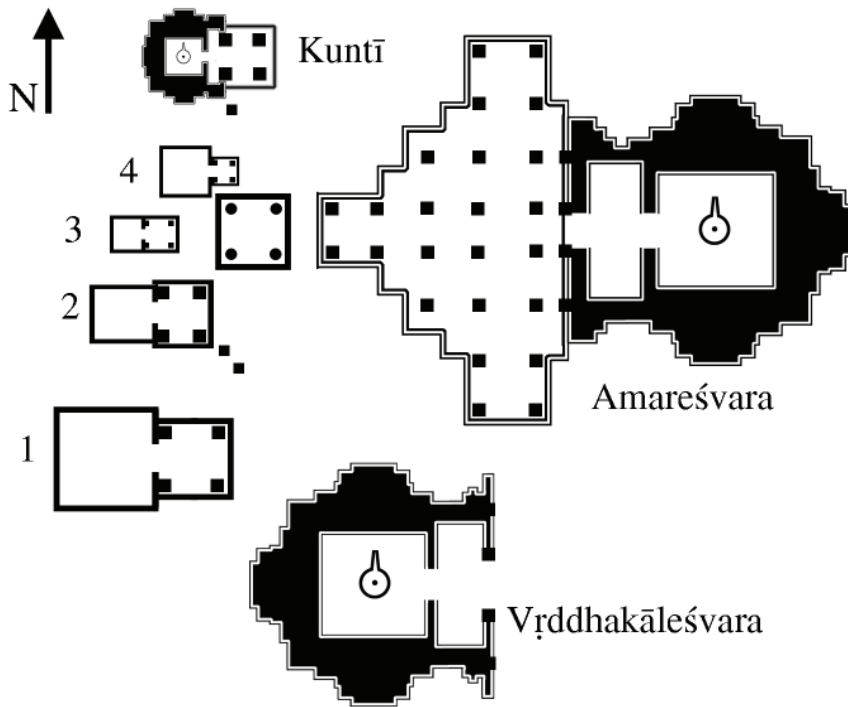

Fig. 1: Schematic ground-plan of the Amareśvara temple complex (not to scale).

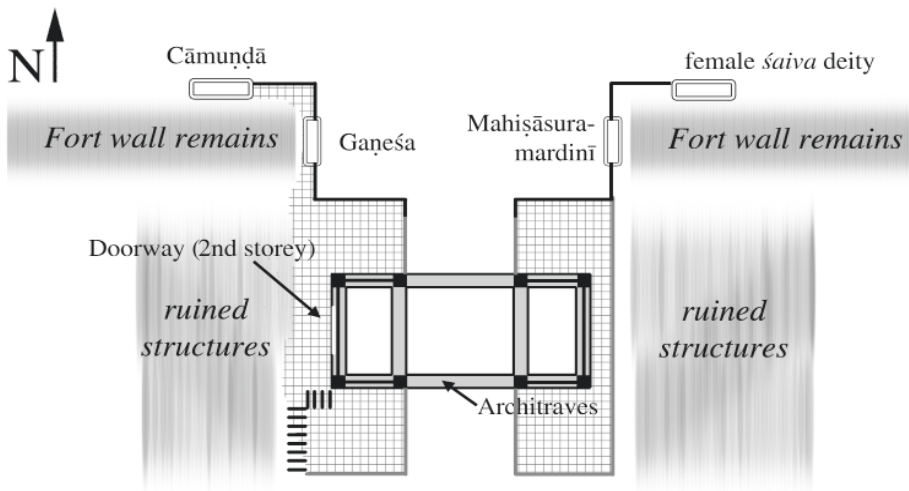

Fig. 2: Schematic ground-plan of the North or Cāndsūraj gate (not to scale).

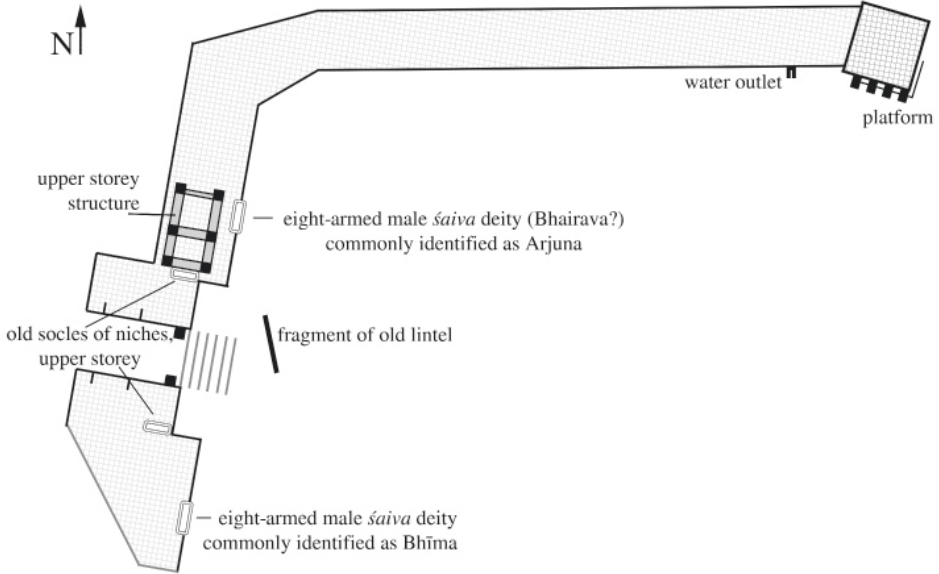

Fig. 3: Schematic ground-plan of the East or Bhīmārjunī gate and adjacent remains of the inner fort-wall (not to scale).

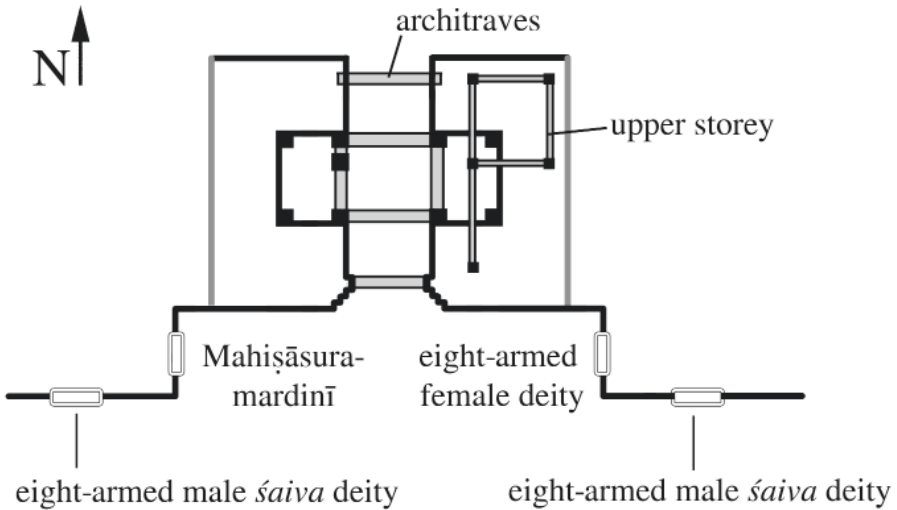

Fig. 4: Schematic ground-plan of the South gate (not to scale).

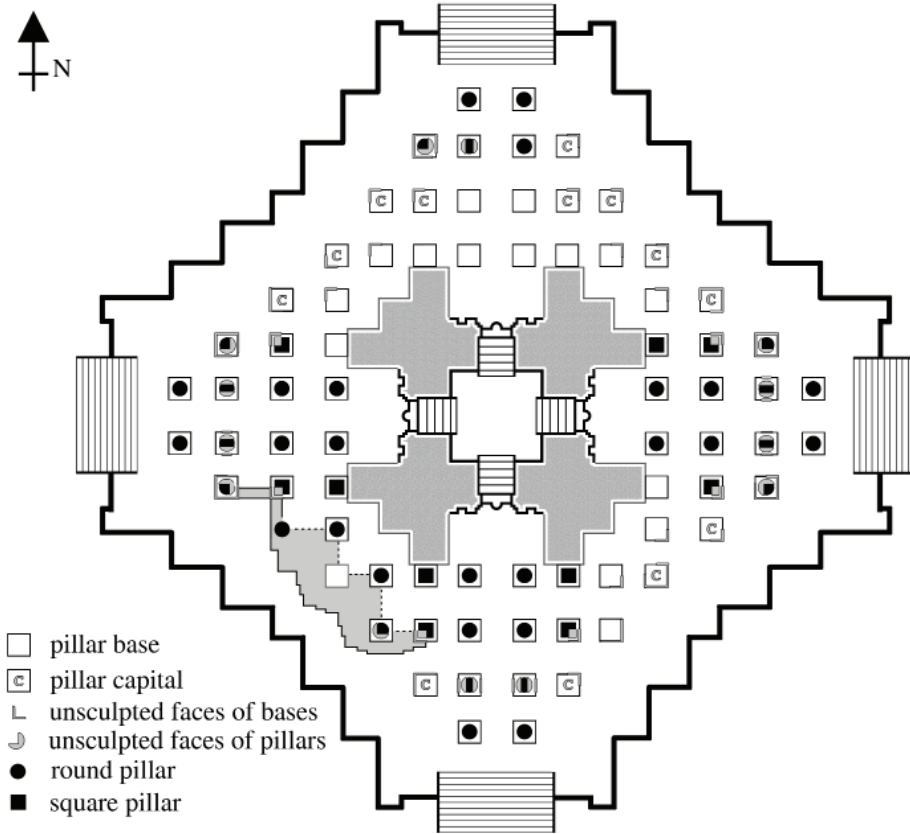

Fig. 5: Schematic ground-plan of the Siddhanātha temple.

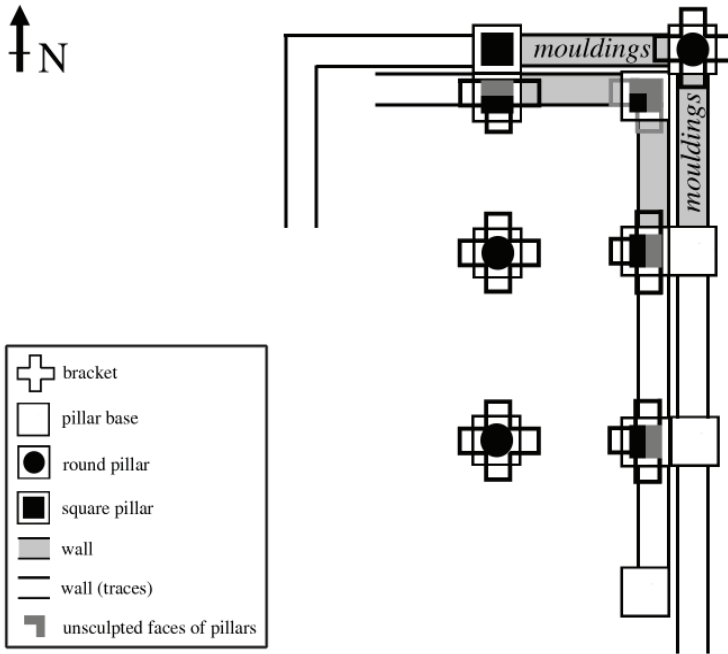

Fig. 6: Schematic ground-plan of structure E2 (not to scale).

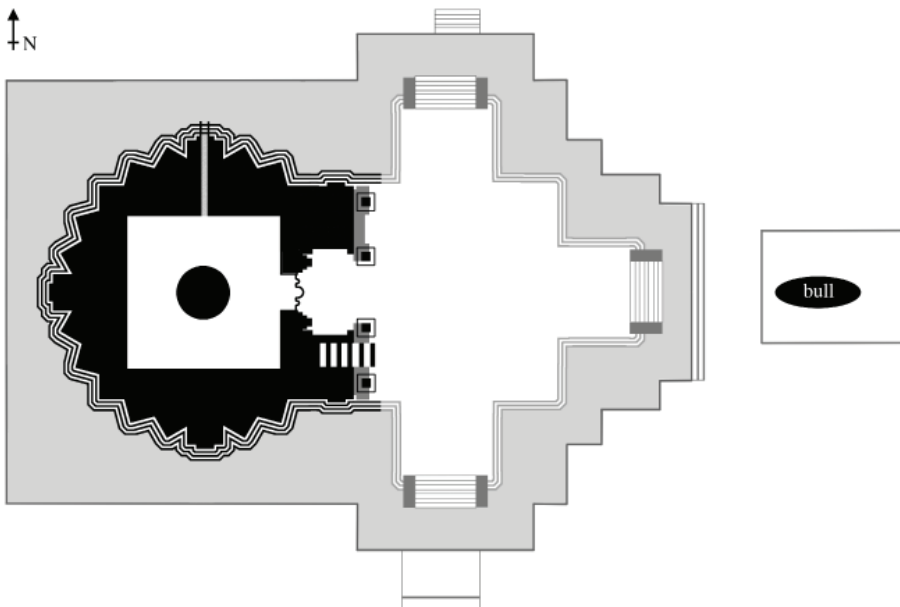

Fig. 7: Schematic ground-plan of the Gaurīśomanātha temple (not to scale).

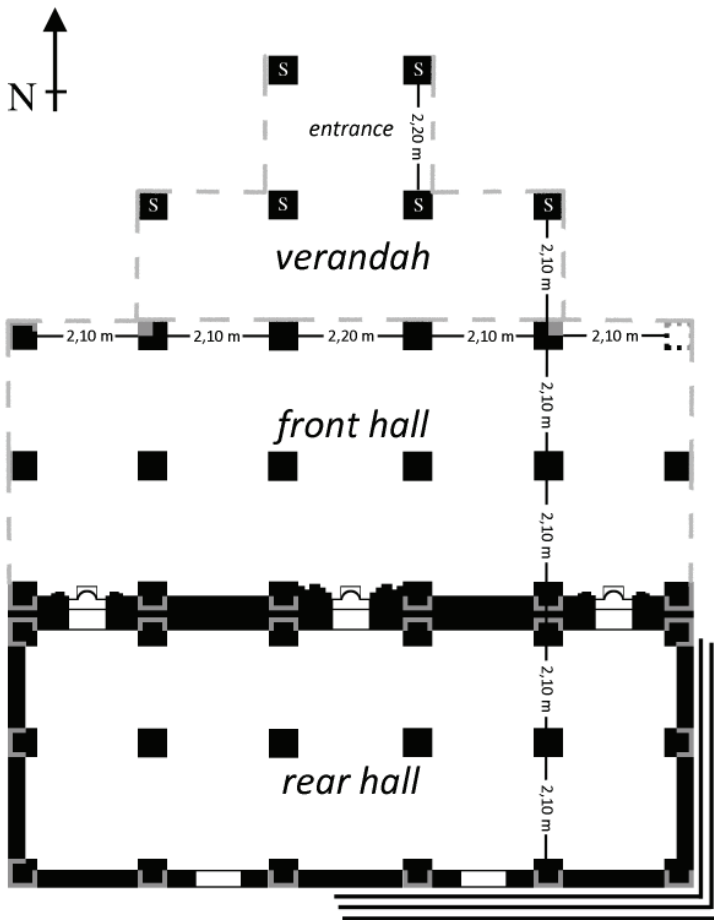

Fig. 8.1: Schematic ground-plan of the Dhavalimath (not to scale).

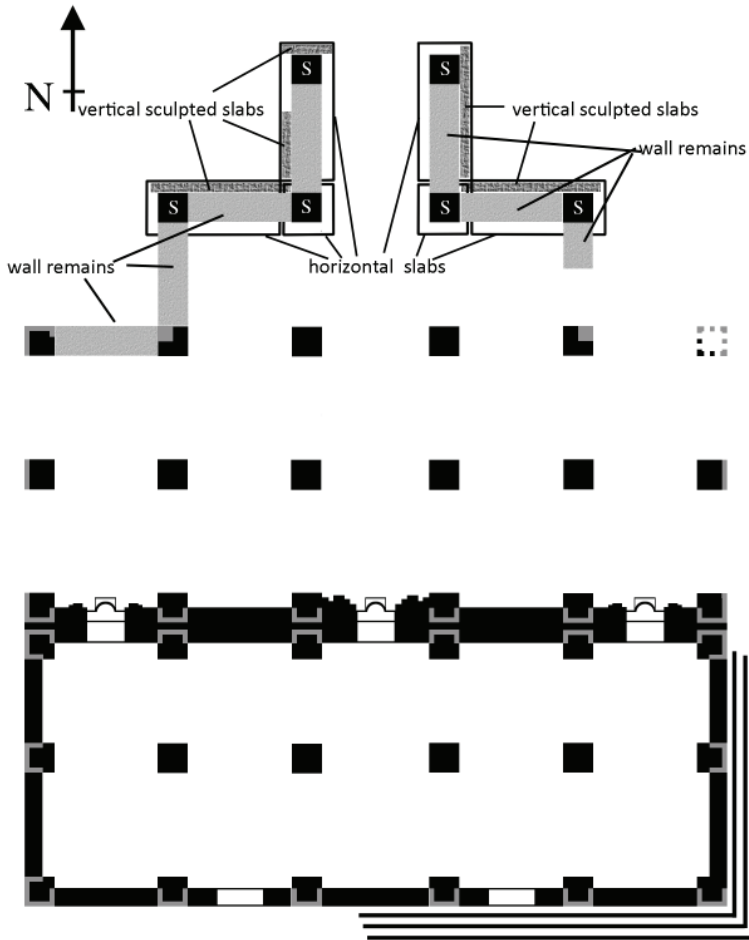

Fig. 8.2: Schematic ground-plan of the Dhavalimāṭh, detail of the verandah (not to scale).

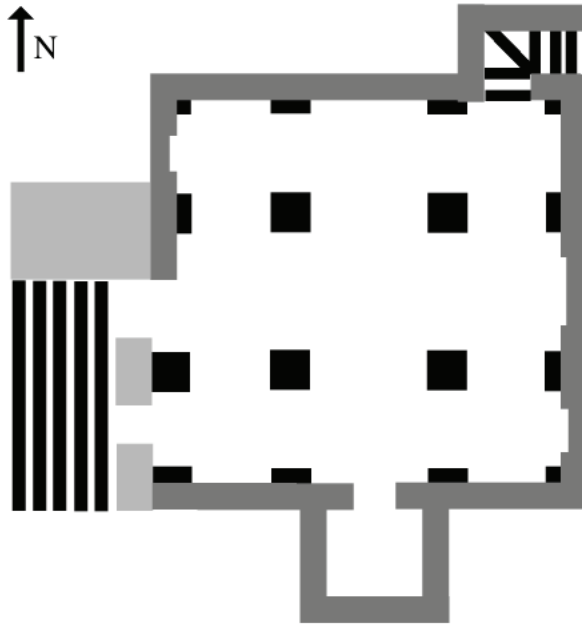

Fig. 9: Schematic ground-plan of the Kālikāgūphā (not to scale).

